



Microframe has a sash profile with a front view of only 39 mm and an extruded thermal break aluminum frame profile to our specific design.

In this extreme design solution there is only the sense of the flush sash, with total disappearance of the frame for a minimalist design.

The central section of the two sashes is only 59 mm enhancing the minimalist design.

The use of the latest top-of-the-line gaskets ensures excellent sealing and insulation.

The movement system is strictly by design with concealed hinges and multiple locking points through dedicated hardware to give maximum safety and aesthetic performance.



Materials:
Wood/Aluminium



Triple glazing:
Thickness 51 mm



Thermal insulation:
Hardwood 0.93 Uw



Soundproofing:
Possibility of acoustic glass



Safety:
High anti-burglary



Air permeability:
Class 4



Water tightness:
Class E1650









Wind load:
Class C5



Model filed at
Adi, Milan, Italy

- Values referred to the relevant European standards on a sample with two sashes 1500 x 1500 mm, in 2018.
- The photos are for representation only.

PLUS

 Performance	<ul style="list-style-type: none"> • Excellent thermal and acoustic performances for greater living comfort. • Greater cost savings for heating and cooling.
 Construction	<ul style="list-style-type: none"> • Eco-sustainable materials: FSC certified timber from controlled forests. • Solid wood without veneers and lamella joints, for a esteemed and non-industrial product. • Certified glues resistant to humidity and heat, long-lasting. • «Made Fabbio» extruded aluminum for less maintenance and longer life, 100% recyclable.
 Components	<ul style="list-style-type: none"> • High performance extra-clear/acoustic triple glazing. • Glass spacer in super-performing material with very low heat conductivity. • Standard anti-burglary concealed turn/tilt-and-turn hardware, 115° opening, load capacity 150 Kg.
 Painting	<ul style="list-style-type: none"> • Non-toxic and harmful-free water-based paint products (Microframe is compatible with Bio paints) • Aluminum treated with high-strength paints, upon request "Qualicoat" paint conforming to "Seaside" class.
 Design	<ul style="list-style-type: none"> • The section of wood is so thin that it provides very high brightness to the room. • Microframe has the thinnest section in the wooden window market. • Compatible handles have minimalist design lines made specifically for Microframe. • The central section is symmetrical, and the handle is in the center to have more aesthetic cleanliness. • The gasket on the sash is not visible. • The overall aesthetics of the window is essential due to the designed microdesign.
 Installation	<ul style="list-style-type: none"> • The assembly and disassembly of the window frame is simple and does not require invasive work on the masonry. • The products used for the installation are certified and guaranteed by "Posa Casaclima". • Fabbio Design holds the certification of "EQF4 Certified Installers" (the highest rating).

TECHNICAL INFO

Section

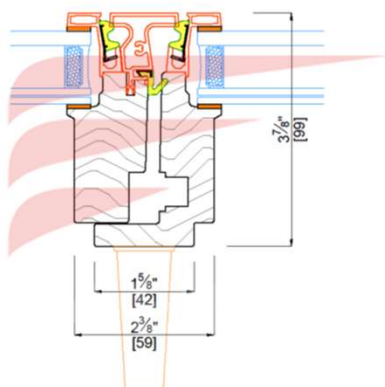
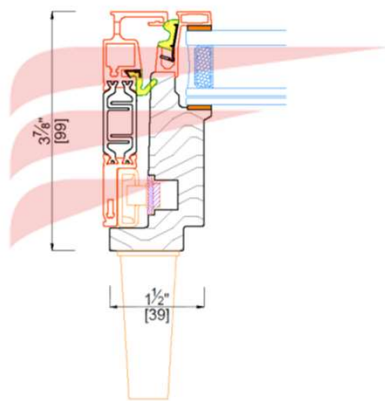

Dimensions

Minimum and maximum dimensions are approximate and vary depending on the glass and hardware used

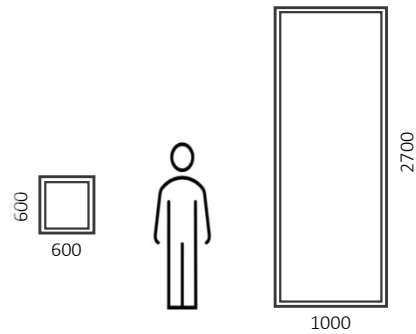

Types of opening

Representative examples

